

Introduction to ECHO

In February 2012, Emmanuel Parish Church completed a £355,000 re-build and refurbishment of the Church hall, now known as ECHO: Emmanuel Church Hall Outreach.

With this extensive refurbishment has come new and thoroughly updated facilities. They provide a number of opportunities for all your needs, accommodating anything from conferences and public meetings to training and education.

More details can be found overleaf with a plan of the hall itself. We have three new rooms with the Jubilee, Rainbow and Huntcliffe rooms available plus a commercial-style kitchen and small tea-bar according to your needs for refreshments.

For larger scale needs, the Church itself is available to book, offering the perfect setting for concerts etc. You can also book the entire hall, however advance booking is a necessity.

The main aim of this new and updated hall is to provide new facilities available for mission and outreach projects to improve the social and spiritual life of the local community, and for other groups who aim to improve the community they represent.

For more information, please visit:
www.emmanuelstburn.co.uk

ECHO is ideal for:

- Conferences
- Family Parties
- Church retreats
- Meetings
- Charity Fundraising events
- Concerts
- Theatre Productions
- Wedding receptions
- Day and evening classes
- Adult learnings classes
- Training days
- Workshops
- Quiet Days

For a booking application form please contact:

Parish Administrator
Tel: 01287 622251
E-mail: emmanuelstburn@hotmail.co.uk

Emmanuel Church Office,
Macnay Street,
Saltburn-by-the-Sea,
TS12 1LE.



Emmanuel Church Hall Outreach





The **Hall** provides 175sq metres of space for a range of activities and can seat up to 100 people around tables and 300 theatre-style. ECHO holds a Premises Licence for Entertainment up to 11.00pm.

The commercial-style **kitchen** is accessed via the hall and offers cooking, tea & coffee, microwave and dishwasher facilities.



The hall and church facilities can be booked by the hour, by the session or by the day.

Our current fees are available from the Parish Administrator upon request - contact details are on the back of this leaflet.

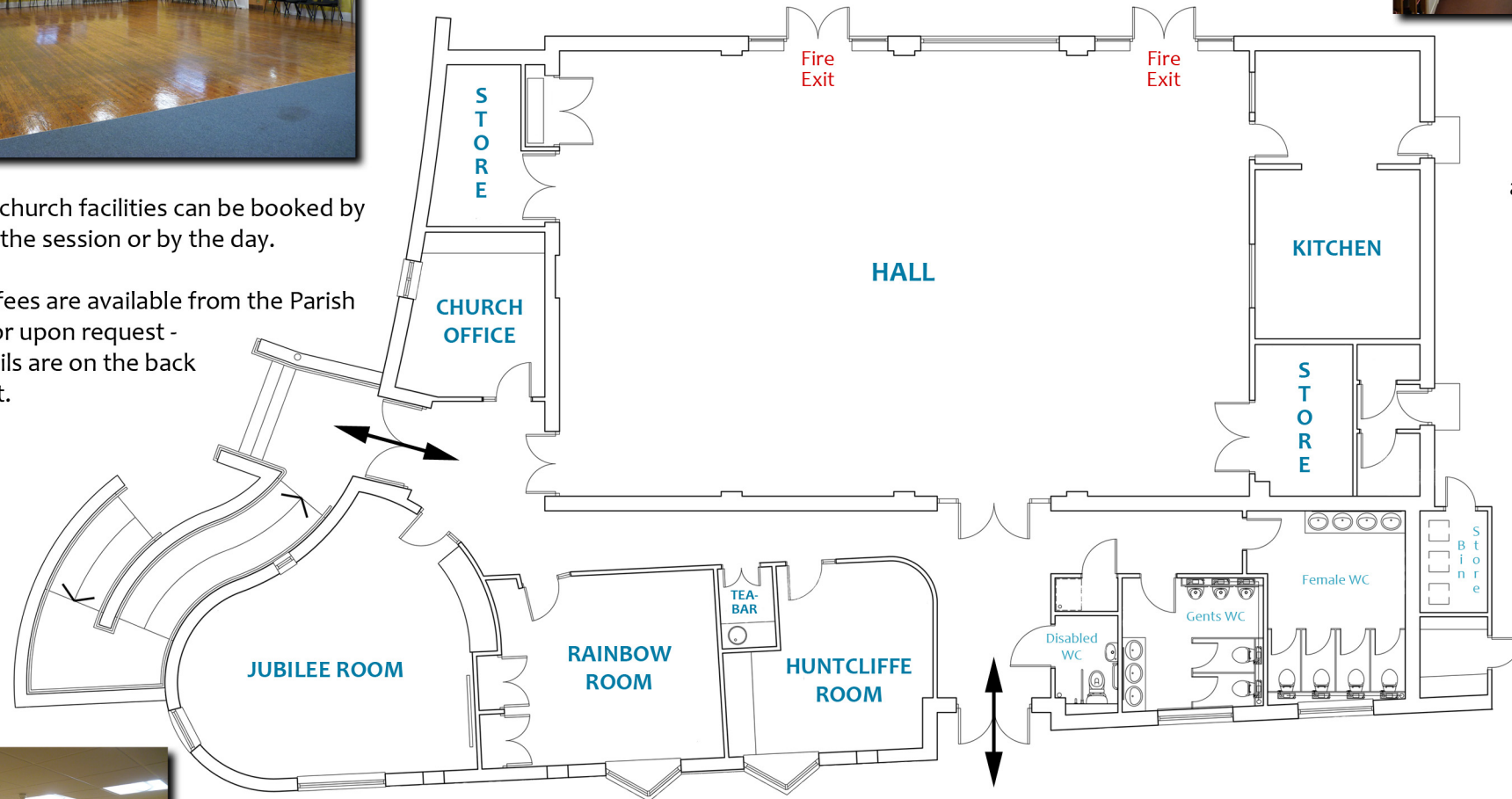

A **Tea-bar** is available enabling all rooms to be in use without accessing the main kitchen facility should the Hall be in use.



Arrangements can be made on your behalf for food to be provided upon request.



The **Jubilee Room** offers good training and small conference facilities in addition to more formal meetings. Includes IT* facilities, with a TV+DVD player. There is seating for up to 40 in theatre-style, and 25 around tables. Wi-fi is available upon request.



The **Rainbow Room** offers facilities for craft/workshop, drop-in and meeting events.



The **Huntcliffe Room** offers computer facilities for small meeting and drop-in events.

Computers are not provided.